

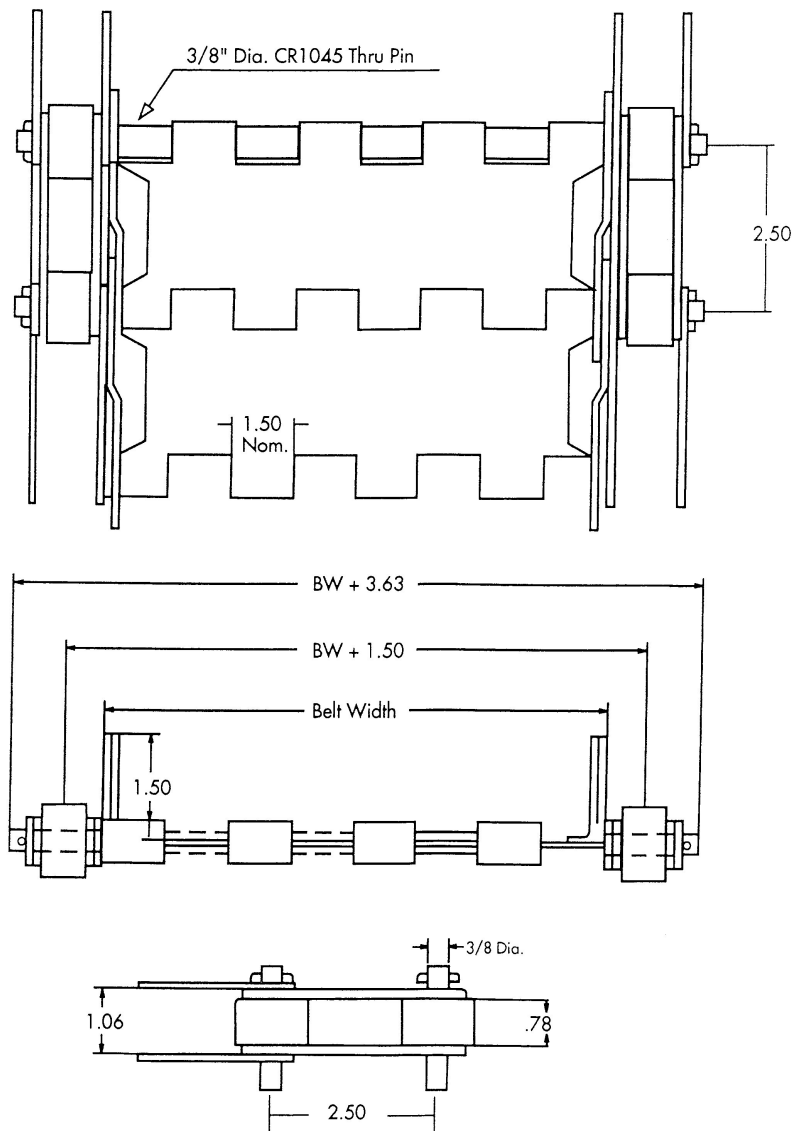

**2-1/2" Pitch Steel Hinge Belting (#2512)**

- ✓ 2500 Pound Maximum Belt Pull
  - ✓ 1/8" Thick Pans
  - ✓ 0.16" x 1" Chain Bars
- ✓ 1-9/16" Diameter x 3/4" Face, Hardened Sintered Steel Rollers
  - ✓ Heat Treated Roller Bushings
  - ✓ C1045 Belt Pins
- ✓ Plain, Perforated, Dimpled Pans Available
  - ✓ Cleats available to suit application



**Cleveland, Ohio USA**

**Phone & Fax: 800-577-0559 Email: [sales@davis-ohio.com](mailto:sales@davis-ohio.com)**

**Web: [www.davis-ohio.com](http://www.davis-ohio.com)**